

B10 Entgratfräser *Deburring milling cutters, Fraises d'ébavurage, Frese per smussatura*

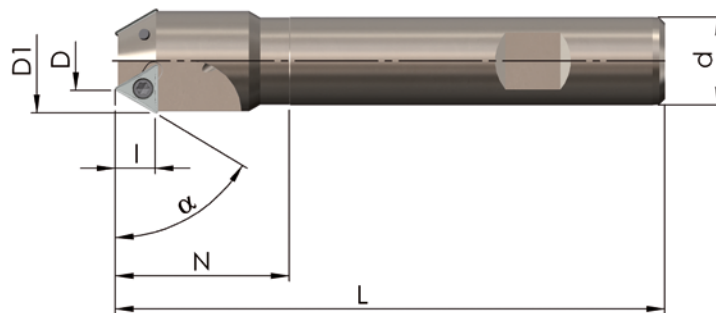

Schafffräser DIN 1835-B *Shank type mills, Fraises à queue Weldon, Frese a gambo Weldon*



Bestell-Nr.	D	D1	α	l	N	L	d	Z
<i>Order-No., Référence, Codice</i>								
EF-30-84-2	6,7	21,60	30°	4,2	52	100	16	2
EF-45-84-2	7,0	18,90	45°	5,9	52	100	16	2
EF-60-84-2	10,7	19,35	60°	7,3	52	100	16	2

B10 Vorwärtssenker *Counterboring mills, Fraises à lamer, Frese per lamatura*



DIN 974 T1 Reihe 1
(DIN 74 Form H, J, K)

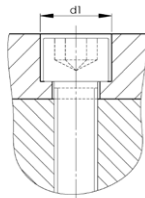

DIN 974 T1 Reihe 5

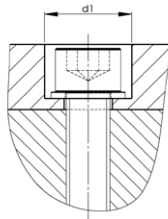

DIN 974 T2 Reihe 3
(DIN 74 Form R)

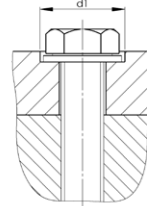

DIN 974 T2 Reihe 1+2
(DIN 74 Form SA, TA, SB, TB)

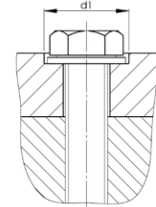

Schafffräser DIN 1835-B *Shank type mills, Fraises à queue Weldon, Frese a gambo Weldon*

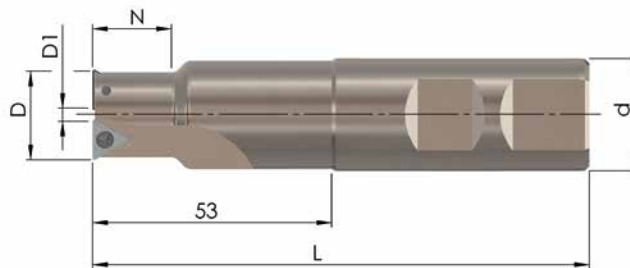

Bestell-Nr. <i>Order-No., Référence, Codice</i>	D	für Gewinde \emptyset <i>for thread \emptyset, pour filetage \emptyset, per filettatura \emptyset</i>					L	d	D ₁	N	Z
		T1/1 (Form H,J,K)	T1/5	T2/1 (Form SA,TA)	T2/2 (Form SB,TB)	T2/3 (Form R)					
VS 90-M12-84	20	M12	-	-	M 6	-	110	25	3,8	18	2
VS 90-M16-84	26	M16	M12	-	M 8	M12	110	25	9,8	53	3
VS 90-M20-84	33	M20	-	M12	M10	M16	110	25	16,8	53	3
VS 90-M24-84	40	M24	M20	M16	-	M20	110	25	23,8	53	3

B10 Fräswendepplatten und Schnittdaten

Milling inserts and parameters, Plaquettes de fraisage et paramètres, Inserti e parametri di taglio

			HT45 (code 31)	HT50 (code 22)	Ti20 (code 1)	HT20 (code 32)	K15M (code 8)		
	JMB10-84R04- IK 5,5x2,7 R0,4 M 	Order-No.		B10A-FH22	B10A-CU01				
		f_z [mm]		0,10 (0,05-0,20)	0,10 (0,05-0,20)				
	JMB10-84AR04- IK 5,5x2,7 R0,4 S 	Order-No.		B10A-AC22	B10A-BN01				
		f_z [mm]		0,10 (0,05-0,20)	0,10 (0,05-0,20)				
	JMB10-284R04- IK 5,5x2,7 R0,4 M S 	Order-No.	B10B-HB31			B10B-GA32			
		f_z [mm]	0,10 (0,05-0,25)			0,10 (0,05-0,25)			
	JMB10-284R02- IK 5,5x2,7 R0,2 U 	Order-No.					B10D-JB08		
		f_z [mm]					0,15 (0,10-0,25)		
	JMB10-284R04- IK 5,5x2,7 R0,4 U 	Order-No.					B10D-KA08		
		f_z [mm]					0,15 (0,10-0,25)		
			20	20	20	20	20		

V_c [m/min]	Stahl Steel Acier Acciaio	Rostfrei Stainless Acier inoxydable Inossidabile	Guss Cast iron Fonte Ghisa	NE-Metalle Non-ferrous metals Non ferreux Metalli non ferrosi	Hochwarmfest Highly heat-resistant Superalliages Resistente al calore	Gehärtet Tempered Aciers traités Temprato
HT45	250 (200 - 350)	240 (140 - 300)	240 (130 - 280)			
HT50	220 (160 - 300)	200 (100 - 300)	260 (200 - 300)			
Ti20	250 (220 - 280)	220 (180 - 300)	260 (180 - 350)			
HT20			260 (180 - 350)			80 (40 - 120)
K15M				600 (400 - 800)		

Ersatzteile Spare parts, Pièces de rechange, Parti di ricambio

	SS 2,5-1 (M = 1,2-1,3 Nm)		T 08		Fett Grease, Graisse, Grasso
---	-------------------------------------	---	-------------	---	--